

SUBJECT PROPERTY

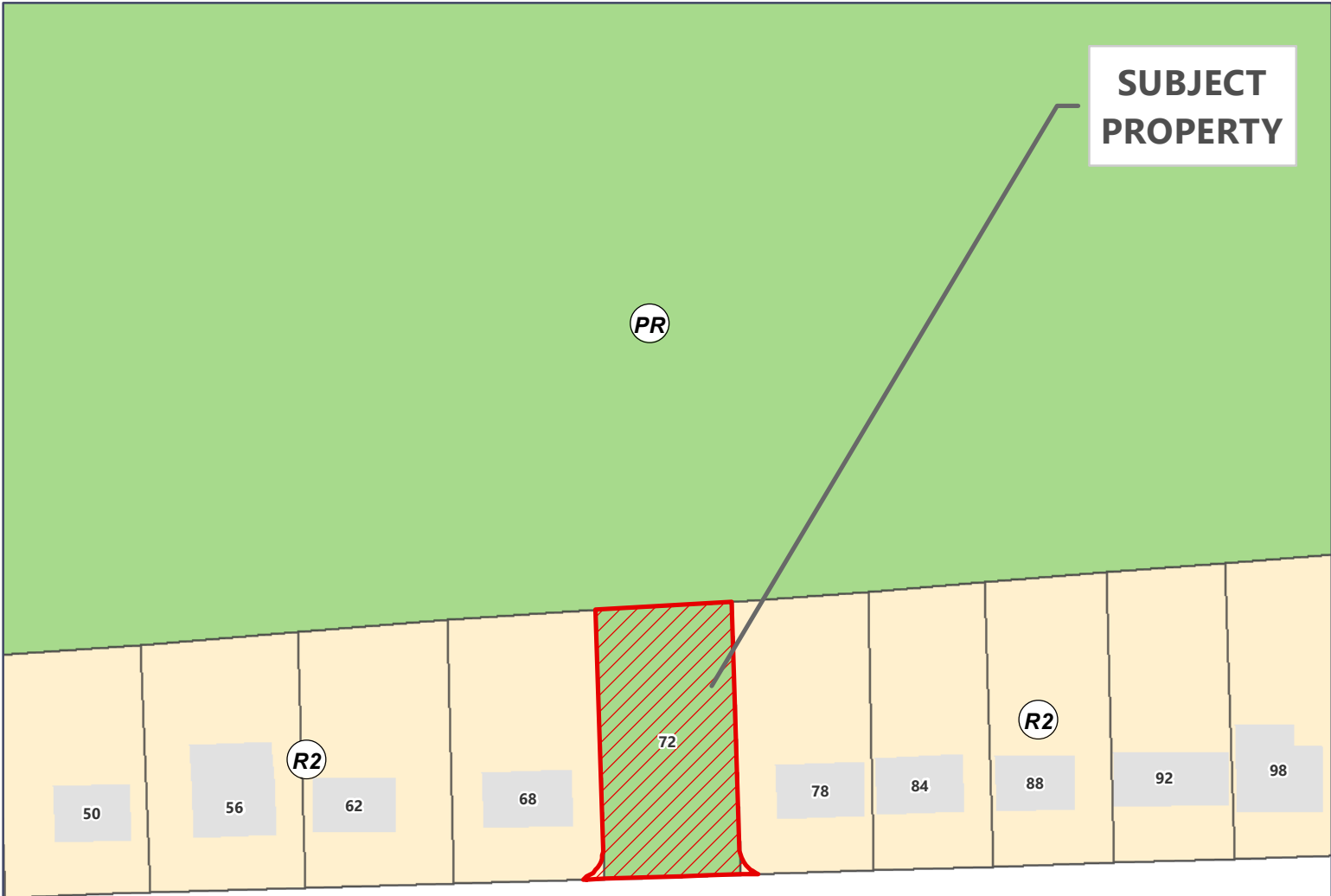

COREY AVENUE

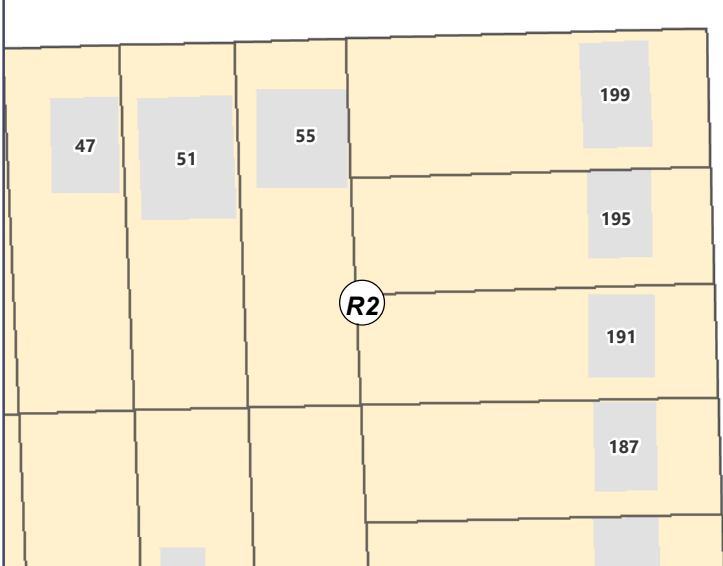

WIBER STREET

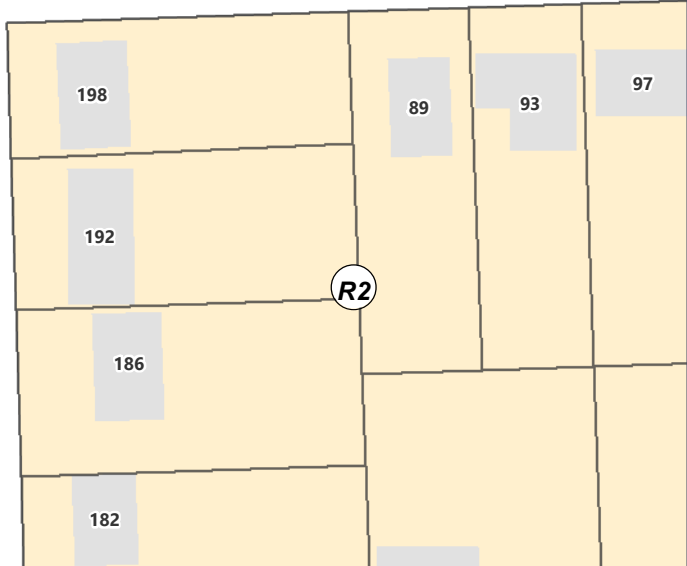

Application A-9-25-Z: Existing Zoning

Property Information



Planning and Enterprise Services

Community Development and Enterprise Services Department

99 Foster Drive, Sault Ste Marie, ON P6A 5X6

saultstemarie.ca | 705-759-5368 | planning@cityssm.on.ca

- C1 - Traditional Commercial Zone
- C2 - Central Commercial Zone
- CT2 - Commercial Transitional Zone
- C3 - Riverfront Zone; C3hp
- C4 - General Commercial Zone; C4hp
- C5 - Shopping Centre Zone
- HZ - Highway Zone
- M1 - Light Industrial Zone
- M2 - Medium Industrial Zone; M2hp
- M3 - Heavy Industrial Zone
- R1 - Estate Residential Zone
- R2 - Single Detached Residential Zone; R2hp
- R3 - Low Density Residential Zone
- R4 - Medium Density Residential Zone
- R5 - High Density Residential Zone
- R6 - Mobile Home Residential Zone
- I - Institutional Zone
- EM - Environmental Management Zone
- PR - Parks and Recreation Zone
- RA - Rural Area Zone
- RP - Rural Precambrian Uplands Zone
- REX - Rural Aggregate Extraction Zone
- AIR - Airport Zone
- Named Use - Commercial Dock

Civic Address: 72 Corey Avenue
 Roll No.:
 Map No.: 46
 Date Created: September 3, 2025

0 10 20 m

1:1,000

This map is for general reference only.

